

Hereby, Thousandshores Deutschland GmbH declares that the radio equipment type Portable Wireless Speaker BTS25S is in compliance with Directive 2014/53/EU.

The full text of the EU declaration conformity is available at the following internet address:

<http://files.tribit.com/bts25s-eu-doc.pdf>

Hiermit erklärt Thousandshores Deutschland GmbH, dass der Funkanlagentyp Portable Wireless Speaker BTS25S der Richtlinie 2014/53/EU entspricht.

Der vollständige Text der EU-Konformitätserklärung ist unter der folgenden Internetadresse verfügbar:

<http://files.tribit.com/bts25s-de-doc.pdf>

Learn more about the UK Declaration of Conformity, Please click below link to download.

<http://files.tribit.com/bts25s-uk-doc.pdf>

Tribit®

Portable Wireless Speaker

MaxSound Plus



User Manual

BTS25S

Contents

English User Manual	01
Benutzerhandbuch	13
Guide Utilisateur	24
Manual de Usuario	35
Manuale Utente	46
取扱説明書	57
用户手册	67

Safety Precautions

- Avoid dropping the speaker on the floor.
- Do not try to disassemble or repair the speaker unless you are a technician.
- Do not submerge the speaker in water.
- Never expose the speaker to extreme high or low temperatures.
- Stop use immediately if thunderstorm happens.
- Do not clean its surface with any corrosive cleanser or other chemical solutions.

Specifications

- Bluetooth version: V5.0
- Bluetooth profile: A2DP, AVRCP, HFP, HSP
- Driver: 2 x Φ 45mm Passive radiator
- Output power: 2 x 12W
- Signal-to-noise ratio \geq 80dB
- Frequency response: 80-20KHz
- Frequency band: 2.402GHz~2.480GHz

- Frequency band: 2.402GHz~2.480GHz
- Maximum transmission power: ≤ 6 dBm
- Battery: (7.4V 2200mAh)/ 16.28Wh
- Music play time: Up to 20 hours (varies by volume level and music files)
- Charging time: 4 hours @ 5V/1.5A
- Dimensions: 65x198x68 mm / 2.56x7.79x2.68 in
- Weight: 595g / 20.98oz

What's in the Box



▲
MAXSound Plus



▲
User Manual



▲
USB-C Cable



▲
Lanyard



▲
Audio Line

Overview Buttons & Indicators

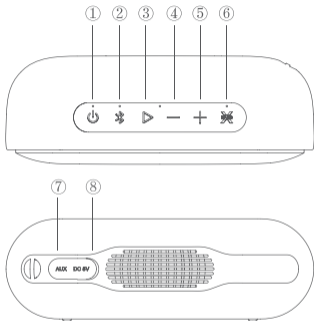

① Power Button
Indicator

② Bluetooth Button

③ MFB Taste

④ Volume -

⑤ Volume +

⑥ EQ Mode Button
Indicator

⑦ AUX-IN Port

⑧ Charging Port

Connections

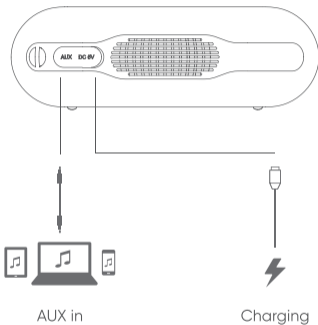

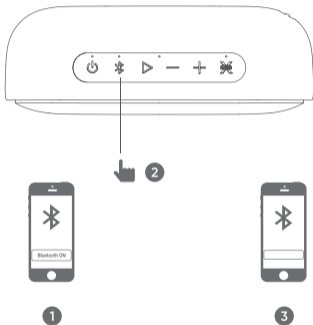

Bluetooth Pairing

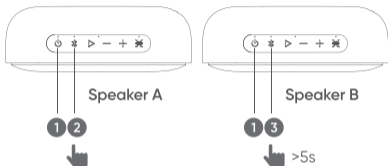

Stereo Mode



- ①. Make sure both speakers are on.
- ②. Press  on one of the speakers to enter pairing state.
- ③. Press  on the other speaker for 5s, then release the button to enter Stereo pairing when you hear the "Stereo mode". When you hear "Left channel" on the left speaker and "Right channel" on the right speaker, the "Stereo mode" is on.

Buttons

Function	Button	Operation
Power ON/OFF	Power Button	Press the button to turn on /off the speaker
Pair a Bluetooth Device	Bluetooth Button	Press the button to manually enter pairing mode
Volume Up	Volume +	Press the button to increase the volume level
Volume Down	Volume -	Press the button to decrease the volume level
Play/pause	MFB	Press once the button
Next track	MFB	Double press the button
Previous track	MFB	Press the button for 3 times

Answer/end the incoming call	MFB	Press once the button
Reject an incoming call	MFB	Press and hold the button for 2s
Voice dial function	MFB	Press and hold the button for 2s to activate (your device must support this function)
EQ Mode	XBASS	Press the button to switch Music normal mode ,Bass and Audiobook mode

Indicators

indicator	Status	
Power indicator	Blue indicator flashes slowly	Reconnection mode

Power indicator	Blue indicator flashes quickly	Bluetooth pairing mode
	Blue indicator keeps steadily on	Connected
	Red light is always on	Charging / battery<20%
	Indicator is off	Battery full
Power display	Mobile phone display	
EQ Mode indicator	White indicator lights up	Bass Mode
	Green indicator lights up	Audiobook Mode
	Lights off	Normal Music Mode

Reset

If this speaker has any problem, you can try to press and hold Volume + and Volume - buttons simultaneously for 5s to reset this speaker and remove the old pairing in your Bluetooth device, and then pair again.

Customer Service

- 18-month limited warranty
- For FAQs and more information, please visit:
Email: support@tribit.com

IC Caution

This device complies with Industry Canada licence-exempt RSS standard(s).

Operation is subject to the following two conditions:

(1) This device may not cause interference, and (2)

This device must accept any interference, including interference that may cause undesired operation of the device.

Le présent appareil est conforme aux CNR d'Industrie Canada applicables aux appareils radio exempts de licence. L'exploitation est autorisée aux deux conditions suivantes: (1) l'appareil ne doit pas produire de brouillage, et (2) l'utilisateur de l'appareil doit accepter tout brouillage radioélectrique subi, même si le brouillage est susceptible d'en compromettre le fonctionnement.

FCC Statement

Changes or modifications not expressly approved by the party responsible for compliance could void the user's authority to operate the equipment.

Changes or modifications not expressly approved by the party responsible for compliance could void the user's authority to operate the equipment.

This equipment has been tested and found to comply with the limits for a Class B digital device, pursuant to Part 15 of the FCC Rules. These limits are designed to provide reasonable protection against harmful interference in a residential installation. This equipment generates uses and can radiate radio frequency energy and, if not

installed and used in accordance with the instructions, may cause harmful interference to radio communications. However, there is no guarantee that interference will not occur in a particular installation. If this equipment does cause harmful interference to radio or television reception, which can be determined by turning the equipment off and on, the user is encouraged to try to correct the interference by one or more of the following measures:

- Reorient or relocate the receiving antenna.
- Increase the separation between the equipment and receiver.
- Connect the equipment into an outlet on a circuit different from that to which the receiver is connected.
- Consult the dealer or an experienced radio / TV technician for help.

This device complies with part 15 of the FCC rules. Operation is subject to the following two conditions:

- (1) This device may not cause harmful interference.
- (2) This device must accept any interference received, including interference that may cause undesired operation.