

Getting Started Guide

WiFi CERTIFIED TAMPER-RESISTANT OUTLET 2ND GEN

Easy Wi-Fi lighting control for the whole home



See the complete line of My Leviton™ app compatible dimmers, switches, plug-ins, and controllers at: leviton.com/decorasmart

1

Welcome



Leviton's second-generation Decora Smart Wi-Fi Tamper-Resistant Outlet provides control of a variety of plug loads, including plug-in lamps, holiday lighting, electronics, and small appliances via the top-controlled outlet.

Use your voice with Amazon Alexa, Google Assistant, or Apple Siri – or use your smartphone or tablet to control the outlet with the My Leviton app, even when away from home. Built-in scheduling allows you to turn devices ON or OFF at specific times, or at sunrise or sunset. A convenient push-button provides manual control. Tamper-resistant protection provides additional safety.

The Decora Smart Wi-Fi Tamper-Resistant Outlet looks right at home with your other Decora brand in-wall devices.

? We are here to help

ONLINE
decorasmartsupport.leviton.com

CHAT
www.leviton.com/support

EMAIL
dssupport@leviton.com

CALL
1-800-824-3005 (USA)
1-800-405-5320 (Canada)

2

Your outlet works with:

- Compatible with general purpose outlet loads up to 15 Amps. For specific ratings, see the chart below.
- Requires an available interior wall box with Line, Neutral, and Ground wires.
- Installation in metal wall boxes or with metal wallplates may result in poor RF performance.
- For indoor use only.
- **WARNING:** Do not use with aluminum wire.
- **Additional self-service support options can be found in the My Leviton app, or at: leviton.com/decorasmart**



RATINGS	
General Use	15A, 120VAC, 60Hz
LED / CFL / Electronic Ballast	5A
Incandescent / Halogen	1500W
Magnetic Ballast	15A
Motor	3/4 HP
Operating Temperature	0°C - 40°C (32°F - 104°F)
Operating Humidity	10% - 90% non-condensing
NETWORK	
Wi-Fi	802.11 b/g/n networks - 2.4GHz only
Security	WPA, WPA2, or WPA3 security, or open
Bluetooth	v5.0
MY LEVITON APP	
iOS	version 12.0 or later
Android	version 8.0 or later

3

At a glance

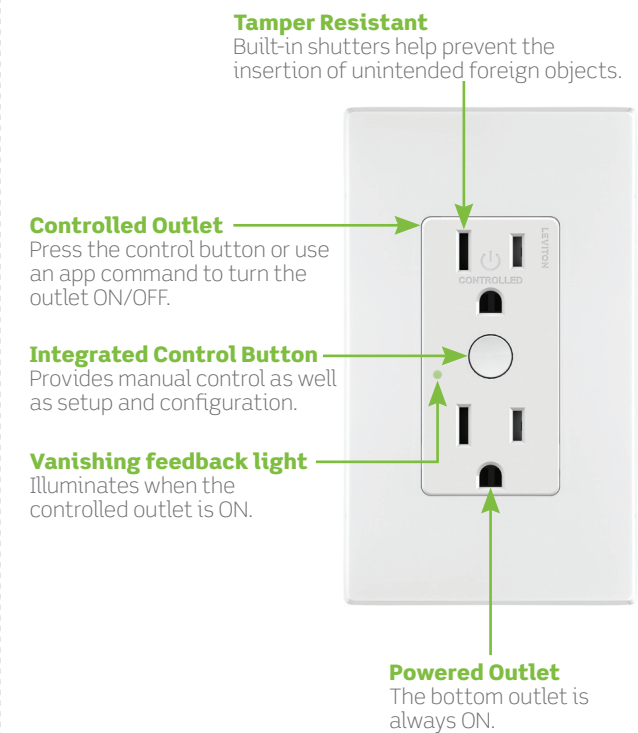

4

Features

- Provides ON/OFF control of a variety of plug loads, including plug-in lamps, holiday lighting, electronics, and small appliances.
- Control the top outlet using the My Leviton app, schedule, voice, or the Apple Home app.
- Works with Alexa, Hey Google, and Apple Siri for voice control.
- Safe tamper-resistant outlets with built-in shutters prevent the insertion of unintended foreign objects.
- Provides two 15A, 120VAC NEMA 5-15R grounding outlets (top-controlled, bottom always ON).
- Add wall mount switch control with Anywhere Switch Companion compatibility.
- Color change kits (DSRKT) are available in Ivory, Light Almond, Black, Grey, Brown, and White.
- My Leviton app settings include Automatic Shut-Off Timer and Status LED Indication.

For more information about features, visit: leviton.com/decorasmart

5

Before you install

Installation requires electrical knowledge. If you are unsure of any steps, consult an electrician.

Things to consider:
For switched control of the outlet from one or more locations, you can pair a wireless DAWSC Anywhere Switch Companion. See Anywhere Switch Companion instructions for connection directions.



What you need to make it work:

- A 2.4GHz Wi-Fi network with high-speed internet.
- An iOS (version 12.0 or later) or Android (version 8.0 or later) mobile device.
NOTE: Make sure that Wi-Fi and Bluetooth are enabled on your mobile device.
- A My Leviton cloud account (set up through the My Leviton app).

6

Installation

WARNING: TO AVOID FIRE, SHOCK, OR DEATH, turn off power at the circuit breaker.

NOTE: Before you install and wire, check to make sure a strong Wi-Fi signal is present at the location where you want to install your outlet.

1. Remove the existing outlet.
2. Verify that you have a Line (Black) wire, Neutral (White) wire, and a Ground (Bare Copper) wire.
 - Line (Black) - Black Screw
 - Neutral (White) - White Screw
 - Ground (Bare Copper) - Green Screw
3. Work only on one connection at a time, and connect your new D215R Outlet as shown.

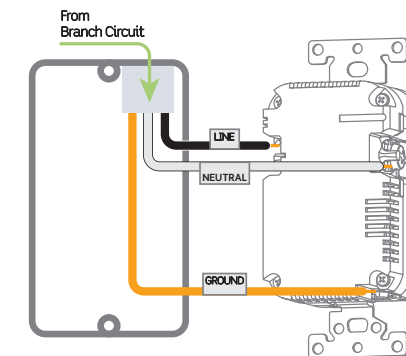

NOTE: Terminals are suitable for copper or copper-clad conductors only.
NOTE: Wire size #14-12 AWG is needed for Hot and Neutral terminals. Conductor strip length is marked on the product. Tighten screws to 14 in.-lbs. (1.6 N-m).

If your back box looks different, consult an electrician.

7

Test and install

1. Restore power. Status LED should flash GREEN, indicating that your outlet is ready to be added to a network.

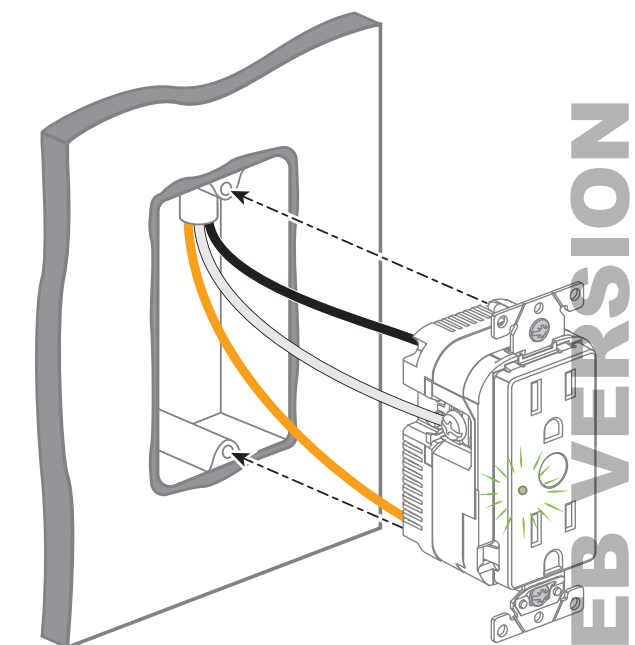

8

If you need help...

- **ONLINE**
decorasmartsupport.leviton.com
- **CHAT**
www.leviton.com/support
- **EMAIL**
dssupport@leviton.com
- **CALL**
1-800-824-3005 (USA)
1-800-405-5320 (Canada)

Leviton Manufacturing Co., Inc.
201 North Service Road, Melville, NY 11747

© 2021 Leviton Manufacturing Co., Inc. All rights reserved.

Specifications subject to change at any time without notice.

Test and install (continued)

Turn off power at the circuit breaker before completing installation of the outlet.

2. Gently push wires into wall box. Screw outlet to box.

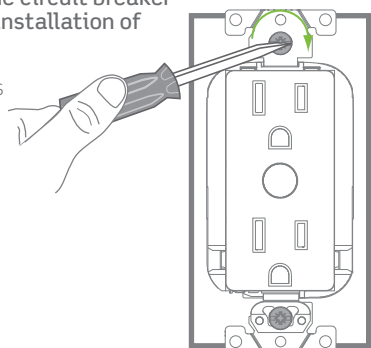

3. Install wallplate base and snap on Decora® wallplate. Restore power.

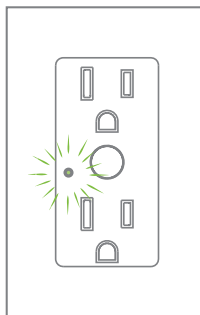

Once power is restored, the status LED will blink GREEN indicating your device is in Setup mode. See page 15 if your Status LED is not blinking GREEN.

Congratulations!
Your Wi-Fi enabled Outlet is installed and ready for setup.

9

Get the app

To download the app, visit my.leviton.com and select the link, or scan the below QR code for your device.

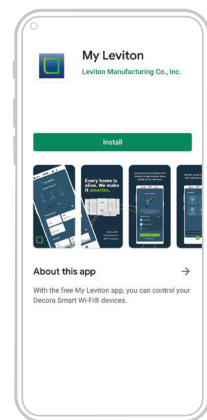
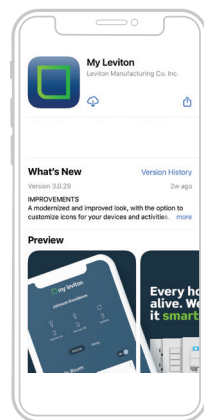

10

Device setup

- Decora Smart Wi-Fi 2nd Gen devices can be connected to the My Leviton service, Apple HomeKit, or both.
- For voice control with Amazon Alexa or Google Assistant, you will need to set up the device with My Leviton.
- For voice control with Siri, you will need to connect your device to Apple HomeKit. See page 14 for instructions on how to add your device to Apple HomeKit.

Add your device to My Leviton



1. Make sure the device is in Setup mode (status LED should be blinking GREEN). If the status LED is not blinking GREEN, see page 15 for instructions on how to put the device in Setup mode.
2. Launch the My Leviton app.
3. Log in or choose “Sign Up” to create a new account.
4. Follow the instructions on the screen.
5. Once logged in, tap the “+” in the upper right-hand corner and select “Add Device”.
6. Follow the app instructions to add your device and connect it to your home Wi-Fi network.

11

Test My Leviton app control

1. Open the My Leviton app.
2. Tap icon to turn ON/OFF.

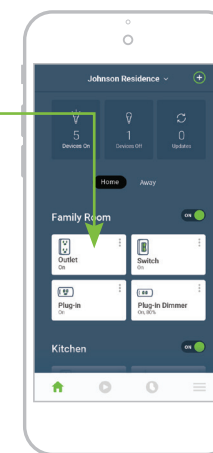

Quick tip

- The My Leviton app includes many features such as: scheduling, remote control, Vacation mode, auto shut-off, activities, room scenes, and advanced options for status LED indication.
- Additional self-service support options can be found in the My Leviton app or at: leviton.com/decorasmart

12

Connect to My Leviton partners (optional)

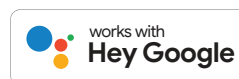

Visit my.leviton.com for a complete list of compatible smart home products.

1. Tap menu icon in lower right corner.



2. Tap Integrations, locate the desired service, select it, and follow the instructions.

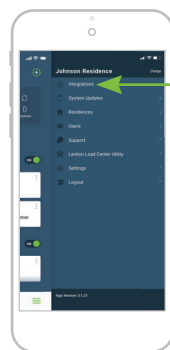

13

Add your device to Apple HomeKit (optional)



NOTE: Skip step 1 if your device is already enrolled to My Leviton and on your Wi-Fi network.

1. Make sure the device is in Setup mode (status LED should be blinking GREEN). If the status LED is not blinking GREEN, see page 15 for instructions on how to put the device into Setup mode.
2. Using an iOS device, open the Apple Home app and select “Add Accessory”.
3. Make sure your Decora Smart Wi-Fi Outlet is model number D215R. Locate and scan the HomeKit setup code on the device or on the front page of this Getting Started Guide.
4. Follow the instructions in the Apple Home app.
5. Once the device is set up, you will be able to voice control your Decora Smart Wi-Fi 2nd Gen TR Outlet with Apple Siri.

Diagnostic LED

If your device is not connecting to the My Leviton app, the Status LED can be used as a diagnostic tool. Press the control button for at least 2 seconds (but no more than 7 seconds), and then release. The Status LED will blink a diagnostic code for 2 seconds.

COLOR	STATUS
Amber	Not connected to Wi-Fi.
Red	Connected to Wi-Fi, but not able to connect to the My Leviton cloud.
Green/Amber, Alternating	Connected to Wi-Fi and My Leviton cloud, but unable to set the time from the internet.
Green	Connected to Wi-Fi, and the My Leviton cloud is working properly.

14

Status LED

COLOR	ACTIVITY	STATUS
Green	Flashing	In Setup mode, and ready to be added to a Wi-Fi network.
Green	Slow Blink	Connecting to a Wi-Fi network on power up.
Green or OFF	Solid	Normal operation. Can be configured in a setup.
Amber	Slow Blink	Device is not connected to the Wi-Fi network, but attempting to reconnect.
Green/Amber	Alternating Blink	Device is in wireless Anywhere Companion Pairing mode.
Red	Blink	Wireless Anywhere Companion devices have unpaired or are at maximum number of paired devices.
Green/Red/Amber	Alternating Blink	Identify feature is triggered from the My Leviton app.

Please see My.Leviton.com support for additional diagnostic assistance.

Setup mode

1. Hold control button for 7 seconds until status light turns AMBER. Then release.
2. The status light will flash GREEN. The device is now in Setup mode.
NOTE: To exit, hold control button for 7 seconds while in Setup mode.



15

Factory default reset

1. Hold the control button for 14 seconds.
2. After the first 7 seconds, the status LED will turn AMBER. Continue to hold.
3. After 7 more seconds, the status light will quickly flash RED/AMBER.
4. Release the control button, and the device will reset.

What to do if...

Intermittent operation:

- Confirm that the Load does not exceed its ratings.
- Confirm that the Neutral wire is connected.

Not connected to Wi-Fi:

- If your device is set up in the My Leviton app, select your device and then select “Device Settings”. On the “Device Settings” screen, select “Reconfigure Wireless”.
- Follow the prompts to reconfigure your device and update the Wi-Fi settings.

How do I clean my device?

- To clean, use a damp cloth with mild soap. DO NOT use disinfecting products, including foggers, sprays, or other types of atomized cleaning agents.

Visit leviton.com/decorasmart or contact Technical Services for additional help.

16

Safety first

WARNINGS:

- **TO AVOID FIRE, SHOCK, OR DEATH, TURN OFF POWER** at circuit breaker or fuse and test that power is off before wiring!
- **TO AVOID FIRE, PERSONAL INJURY, OR DEATH, DO NOT USE** for the control of high-power heating appliances, such as portable heaters. There can be unexpected consequences if not used with care. For example, an empty coffee pot can be remotely turned on. If that should happen, your coffee pot could be damaged from overheating. If an electric heater is turned on by remote control while clothing is draped over it, a fire could result. This module will not control lighting that is used with electronic low-voltage and high-frequency power supply transformers, nor high-pressure discharge lamps (HID lighting). This includes mercury vapor, sodium vapor, and metal halide lamps.
- This product is to be installed and/or used in accordance with electrical codes and regulations.
- For indoor use only.
- If you are unsure about any part of these instructions, consult an electrician.

CAUTIONS:

- Save this instruction sheet. It contains important technical data, along with testing and troubleshooting information, which will be useful after installation is complete.
- Use this Tamper-Resistant Outlet with copper or copper-clad wire only.
- Leviton Wi-Fi enabled devices rely on Wi-Fi communication. For customers looking to install a large number of devices, it is recommended to consult the wireless network's access point specifications to determine the maximum number of supported Wi-Fi devices. In some cases, for example large installations, it may be necessary to upgrade to newer high-performance wireless grade access points to ensure proper operation.

ADDITIONAL RATINGS:

- Purpose of Control: Operating Control
- Impulse Voltage: 2500V
- Action Control Type: 1
- Disconnection Type: Micro
- Pollution Degree: 2

Limited 2 Year Warranty & Exclusions

For Leviton's limited product warranty, go to www.leviton.com. For a printed copy of the warranty, call 1-800-824-3005.

FOR CANADA ONLY

For warranty information and/or product returns, residents of Canada should contact Leviton in writing at Leviton Manufacturing of Canada ULC at the attention of the Quality Assurance Department, 165 Hymus Blvd, Pointe-Claire (Quebec), Canada H9R 1E9 or by telephone at 1 800 405-5320.

FCC COMPLIANCE STATEMENT

The enclosed device complies with Part 15 of the FCC Rules. Operation is subject to the following two conditions: (1) This device may not cause harmful interference. (2) This device must accept any interference received, including interference that may cause undesired operation. Any changes or modifications not expressly approved by Leviton could void the user's authority to operate this equipment. This equipment has been tested and found to comply with the limits for a Class B digital device, pursuant to part 15 of the FCC Rules. These limits are designed to provide reasonable protection against harmful interference in a residential installation. This equipment generates uses and can radiate radio frequency energy and, if not installed and used in accordance with the instructions, may cause harmful interference to radio communications. However, there is no guarantee that interference will not occur in a particular installation. If this equipment does cause harmful interference to radio or television reception, which can be determined by turning the equipment off and on, the user is encouraged to try to correct the interference by one or more of the following measures:

- Reorient or relocate the receiving antenna.
- Increase the separation between the equipment and receiver.
- Connect the equipment into an outlet on a circuit different from that to which the receiver is connected.
- Consult the dealer or an experienced radio/TV technician for help.

FCC CAUTION

Any changes or modifications not expressly approved by Leviton Manufacturing Co., Inc., could void the user's authority to operate the equipment.

FCC SUPPLIER'S DECLARATION OF CONFORMITY

Model D215R - Tamper-Resistant Outlet is manufactured by Leviton Manufacturing Co., Inc., 201 N. Service Road, Melville, NY 11747. www.leviton.com This device complies with part 15 of the FCC Rules. Operation is subject to the following two conditions: (1) This device may not cause harmful interference, and (2) this device must accept any interference received, including interference that may cause undesired operation.

IC STATEMENT

This device complies with Industry Canada license-exempt RSS standard(s). Operation is subject to the following two conditions: (1) this device may not cause interference, and (2) this device must accept any interference, including interference that may cause undesired operation of the device.

RF EXPOSURE AND CO-LOCATION

To comply with FCC OET Bulletin 65 and ICSED RF exposure limits for general population and uncontrolled exposure, this device shall be installed and operated with a minimum distance of 79 inches (20 cm) between the radiator and your body. Also, must not be co-located or operated in conjunction with any other antenna or transmitter.

Patents covering this product, if any, can be found on leviton.com/patents.

Copyright and Trademark Information

Decora and Decora Smart are the registered trademarks of Leviton Manufacturing Co., Inc., registered in the U.S., Canada, Mexico and China.
Google and Google Play are trademarks of Google LLC. Alexa, and related logos are trademarks of Amazon.com, Inc. or its affiliates. Apple®, HomeKit®, and Siri® are trademarks of Apple Inc., registered in the U.S. and other countries. IFTTT and the Wi-Fi CERTIFIED logo are trademarks of their respective owners and any use of such marks by Leviton is under license.
Use of the Works with Apple badge means that an accessory has been designed to work specifically with the technology identified in the badge and has been certified by the developer to meet Apple performance standards. Apple is not responsible for the operation of this device or its compliance with safety and regulatory standards.
Use herein of other third party trademarks, service marks, trade names, brand names and/or product names are for informational purposes only, are/ may be the trademarks of their respective owners; such use is not meant to imply affiliation, sponsorship, or endorsement. No part of this document may be reproduced, transmitted or transcribed without the express written permission of Leviton Manufacturing Co., Inc.
Copyright 2021 Leviton Mfg. Co., Inc.